



AR2™ Rear Walking Beam Air Suspension Sales Manual

Pro Gear's Hendrickson AR2™ Rear Walking Beam Air Suspension Sales Manual to assist in identifying your Hendrickson unit.

If you need any assistance identifying the correct transfer case unit for your truck and equipment, contact your Hendrickson replacement part specialists at Pro Gear and Transmission.

Pro Gear Transmission has same day shipping and 1000's of products in stock and ready to ship internationally for your next project.

For parts or service contact the Hendrickson specialists at Pro Gear & Transmission, Inc.

1 (877) 776-4600
(407) 872-1901
parts@eprogear.com

- Maximize payload
- Maximize driver comfort
- Maximize durability

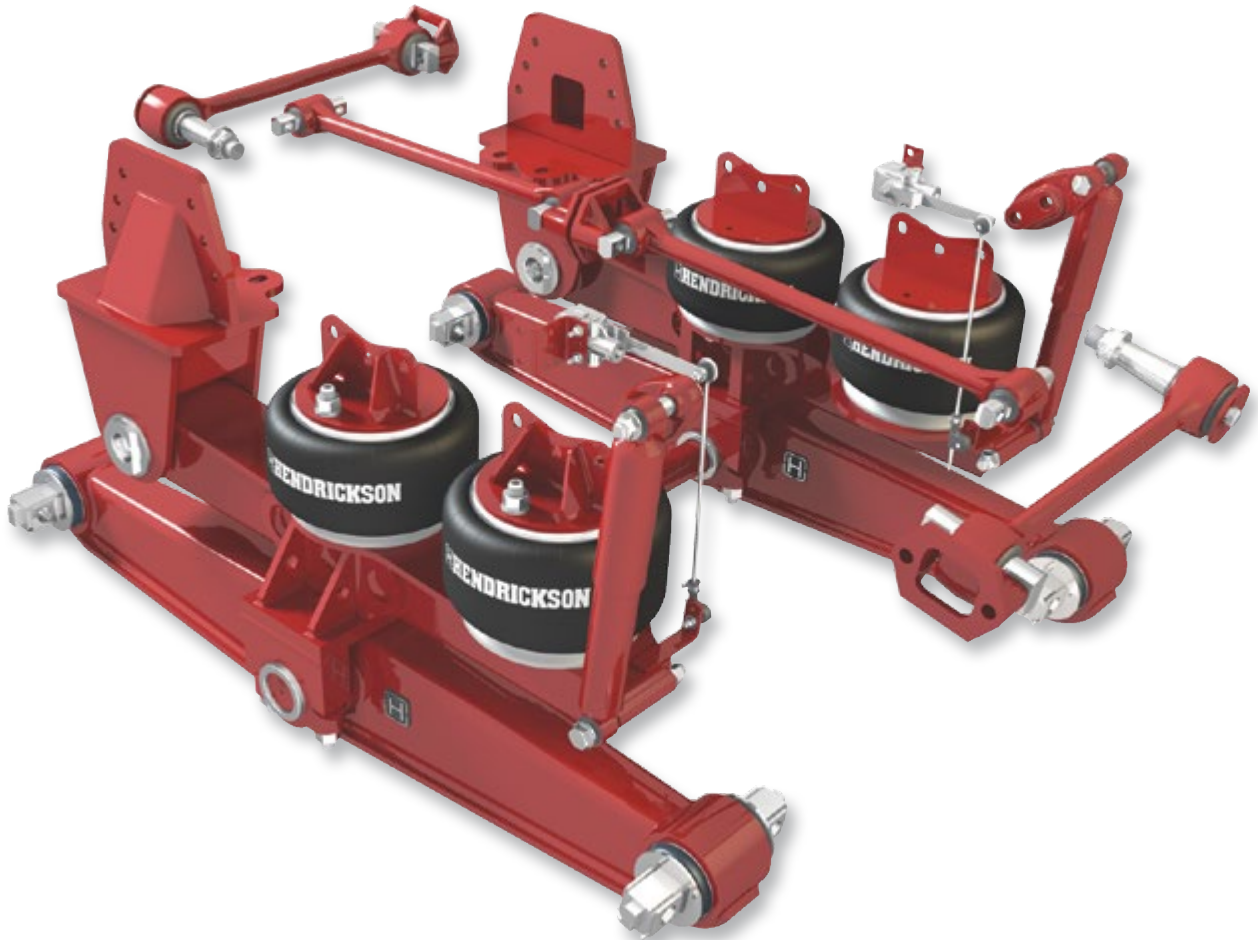

To learn more about the AR2 system,
call 1.866.755.5968 or visit
www.hendrickson-intl.com

H HENDRICKSON
The World Rides On Us®

AR2™ SPRING AIR

Suspension weight is reduced through innovative design, higher strength materials and advanced manufacturing methods for greater payloads and improved durability. The AR2™ suspension delivers the reliability and quality you've come to expect from Hendrickson — the leader in suspension technology and the expert in walking beams.

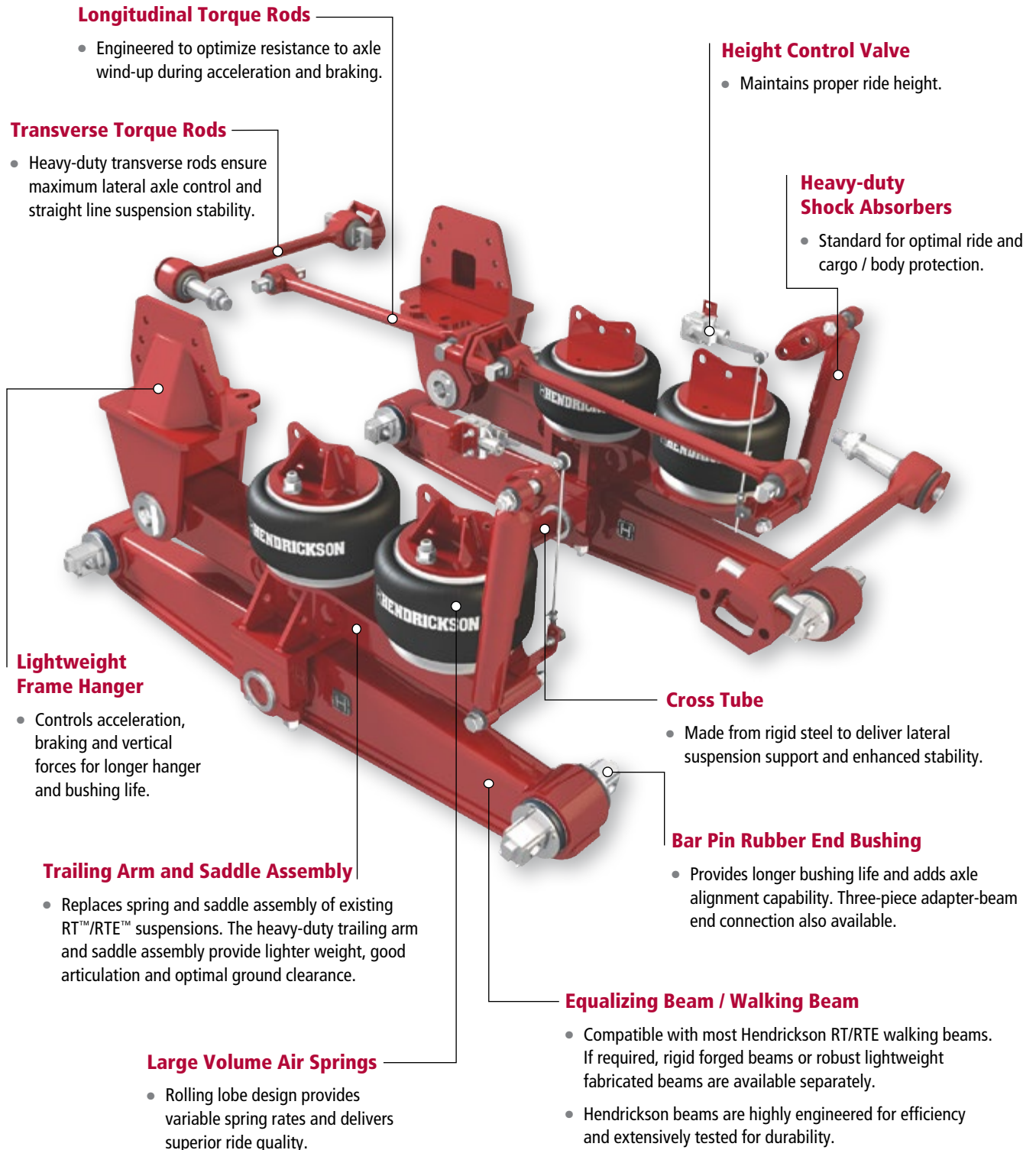

U.S. Patents Granted. Foreign Patents Granted and Pending.

Pro Gear and Transmission • 906 W. Gore St. Orlando, FL 32805 • 1 (877) 776-4600 / (407) 872-1901 • parts@eprogear.com

MAXimize Driver Comfort

“a major improvement
...The ride is 100% better
loaded or empty...”

— Bill Church, Driver
Mark Ward Trucking

The Hendrickson AR2 suspension offers a better ride and improved suspension performance by converting your Hendrickson RT™/RTE™ suspension into a highly engineered and lighter weight walking beam air suspension. The air spring system absorbs the load and road inputs — delivering the preferred combination of empty-ride and loaded stability for vocational applications.

MAXimize Uptime

- Improved ride reduces road shock and vibration to the vehicle to help extend service life and decrease repairs to the cab, chassis and body equipment
- Air springs provide long service life and easy replacement
- Bar pin rubber end bushing extends service life and provides alignment capability. Rubber bushings enhance articulation and help reduce load on mating components
- Hendrickson has manufacturing and distribution centers around the world to ensure the right part is at the right place at the right time.
- Comprehensive technical support

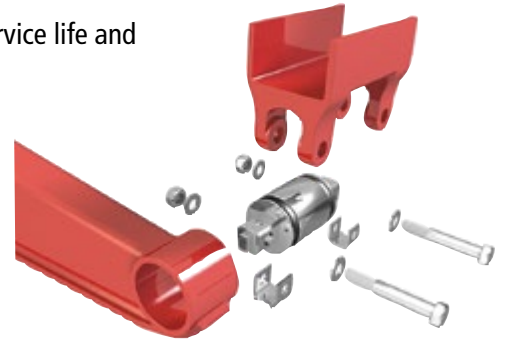

MAXimize Traction



The AR2 suspension provides versatility for demanding job-sites or off-road conditions. When loaded, the system delivers up to 14 inches (356 mm)* of diagonal wheel articulation to help keep load on all drive wheels.

AR2 System Conversion

You still retain benefits from the Hendrickson RT/RTE suspensions, but now you get the additional benefit of a smooth riding air suspension from the world's leading manufacturer of truck and trailer air suspension systems. The AR2 suspension is available in conversion or complete kit form and can be installed by service centers and OEM dealerships who want to give their customers a new suspension solution.

- **What's in the Conversion Kit?** — Two new trailing arm and saddle assemblies, shock absorbers, heavy-duty transverse torque rods, height control valves, four air springs, frame hangers, detailed installation instructions and a parts list.
- Undrilled frame hangers are provided to accommodate numerous hole patterns.
- **What remains of the RT/RTE?** — The existing equalizing / walking beam assembly, cross tube and longitudinal torque rods. AR2 system will fit most RT/RTE suspensions up to 46,000 pound (20,865 kilogram) capacity.

Download Hendrickson's Rear Suspension Application Approval Request form (Lit. No. 58985-000) from the website www.hendrickson-intl.com or e-mail: truckparts@hendrickson-intl.com. Complete the application form and fax or e-mail for approval to help ensure the AR2 suspension is the correct choice for the vehicle and application.

* Suspension articulation may exceed vehicle's capability and may be limited by vehicle manufacturer; vehicle manufacturer installed axle stops may restrict suspension's articulation.

AR2™ Specifications

	CONVERSION KIT ¹				COMPLETE ASSEMBLY			
	AR2 400		AR2 460		AR2 400		AR2 460	
	Pounds	Kilograms	Pounds	Kilograms	Pounds	Kilograms	Pounds	Kilograms
52" (1,321 mm) axle spacing								
Installed Weight ²	664	301	669	303	1,079	489	1,084	492
Suspension Rating ³	40,000	18,144	46,000	20,865	40,000	18,144	46,000	20,865
GVW Approval ⁴	73,000	33,112	80,000	36,287	73,000	33,112	80,000	36,287
GCW Approval	160,000	72,575	190,000	86,183	160,000	72,575	190,000	86,183
Site Travel Rating ⁵	55,000	24,948	60,000	27,216	55,000	24,948	60,000	27,216
Diagonal Articulation ⁶	14" (356 mm)				14" (356 mm)			
Ride Heights	9.5" (241 mm), 10.5" (367 mm)				9.5" (241 mm), 10.5" (367 mm)			
Axle Spacing	52" (1,321 mm), 54" (1,372 mm)				52" (1,321 mm), 54" (1,372 mm)			
Lift Axle	See Below ⁷		See Below ⁸		See Below ⁷		See Below ⁸	

AR2 is approved for vocational truck applications such as dump under 18 feet, crane/boom and platform applications. Contact Hendrickson for approval of additional applications.

1. Conversion kit — if existing RT / RTE suspension includes bronze center bushings, they must be replaced with rubber center bushings. Bronze center bushings are not compatible with transverse torque rods.
2. Conversion kit installed weight includes — torque rods, axle brackets and frame brackets. Complete assembly installed weight includes — fabricated equalizing beam assembly, cross tube, torque rods, axle brackets and frame brackets. NOTE: Any comparison to other suspensions should consider all of these components, including axle brackets.
3. AR2 is also approved for vehicles equipped with Hendrickson aluminum beams up to a 38K maximum capacity.
4. Contact Hendrickson for applications that may exceed GVW approval ratings.
5. Site Travel Rating — Ratings are limited to no more than 5% of vehicle operation at speed not to exceed 5 mph. Site travel ratings are consistent with published axle manufacturer's limitations. Axle and suspension site travel specifications must not be exceeded.
6. Suspension articulation may exceed vehicle's capability and may be limited by vehicle manufacturer; vehicle manufacturer installed axle stops may restrict suspension's articulation.
7. No add-on lift axles for 40K applications.
8. One or more lift axles. Maximum 60,000 pounds (27,216 kg) load on suspension for site travel.

“ We recently had R&H Spring Wall N.J. replace the factory rear suspensions in two of our 2007 Freightliner Condor trucks with Hendrickson AR2 suspensions. The improvements were noticed immediately by both the drivers and workers who operate the specialized pavement marking equipment on the rear of the units. We have noticed less wear and tear of the equipment on the seat of the units due to the smoother ride. This was money well spent! ”

— Kevin P. Coolahan
Shop & Equipment Manager, Traffic Lines Inc.

Hendrickson Genuine Parts are the same quality components installed in Hendrickson original equipment suspensions — consisting of the same design, construction, performance and durability. There's only one way to maintain and protect your suspension's original performance. Ask for the name that is synonymous with the finest manufactured suspensions in the world — Hendrickson.

Call your truck dealer or Hendrickson at **1.866.755.5968** (toll-free) or **1.630.910.2800** for additional information.



www.hendrickson-intl.com

TRUCK COMMERCIAL VEHICLE SYSTEMS
800 South Frontage Road
Woodridge, IL 60517-4904 USA
1.866.755.5968 (Toll-free U.S. and Canada)
1.630.910.2800 (Outside U.S. and Canada)
Fax 1.630.910.2899